

# USINE TURCO-FRANCE DE PROVINS

7123

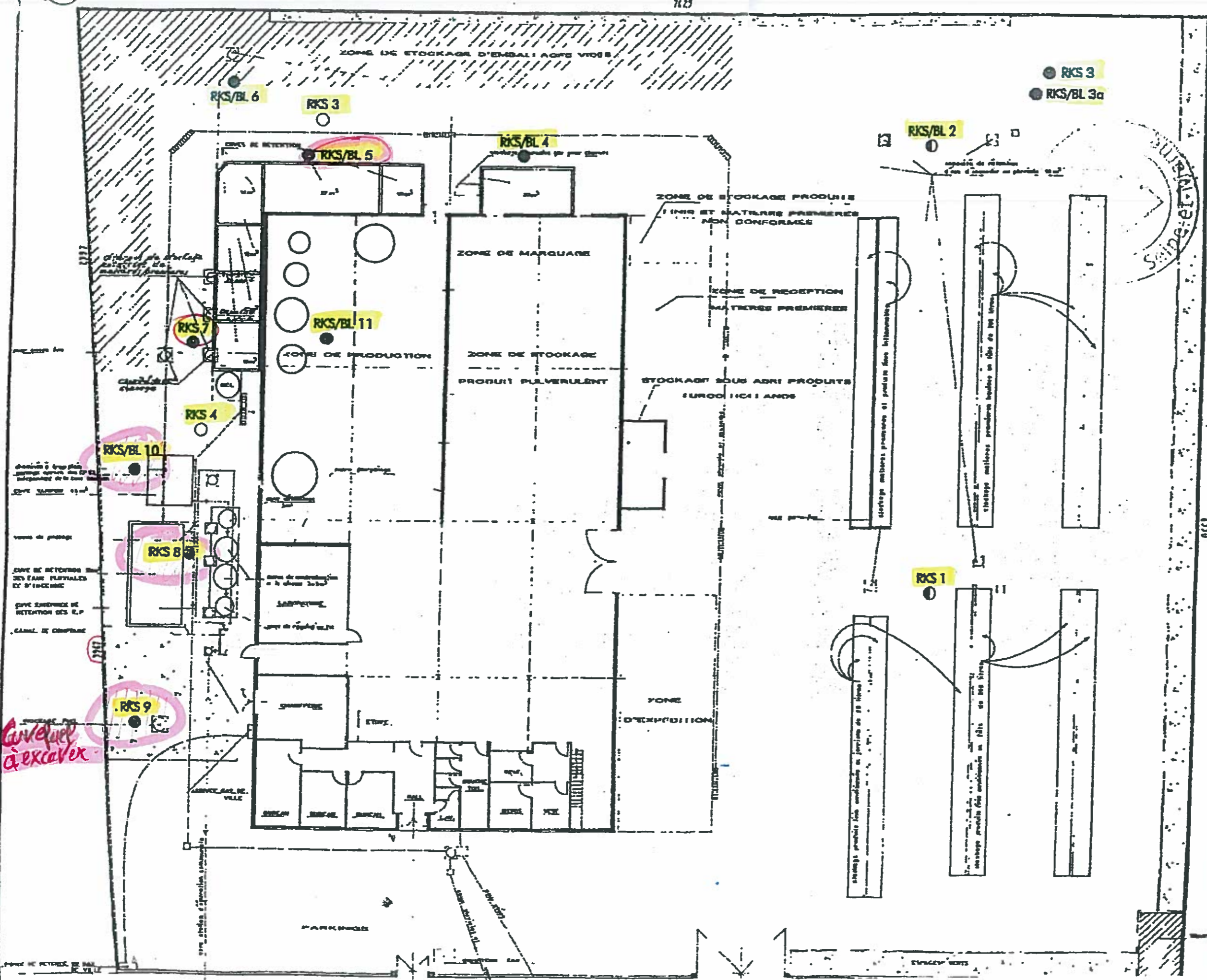

**Legend**

- RKS 1 ● drilling
- RKS/BL 2 ● drilling with soil gas measuring tube
- RKS 1 ○ drilling carried down by Fondasa International on 26.01.1994
- concrete
- unsealed areas

area of previous subsoil tanks

Citerne de stockage enterrées de matières premières

Capacité 20.000 t

Capacité 8.000 t

Capacité 10.000 t

Capacité 10.000 t

0118

à excaver

M&P Partner Ingenieurbüro AG  
 PE, Pflanz  
 Söhlstraße 10  
 41460 Neuss  
 Tel: 02131/70054 Fax: 02131/700541

**M&P**

	Date	Person
	04.04.92	C. Meyer
	04.04.92	K. Müller
		Senior Consultant K. Rein
		Senior Consultant M. Olfert
		Consultant Henkel KGaA

Scale: 1:250

Project: Location of boreholes and soil gas measuring points

Appendix: Figure 02

Site Investigation/Risk assessment on the premises of TURCO FRANCE  
 From: Institut für Umweltwissenschaften der TU Braunschweig